

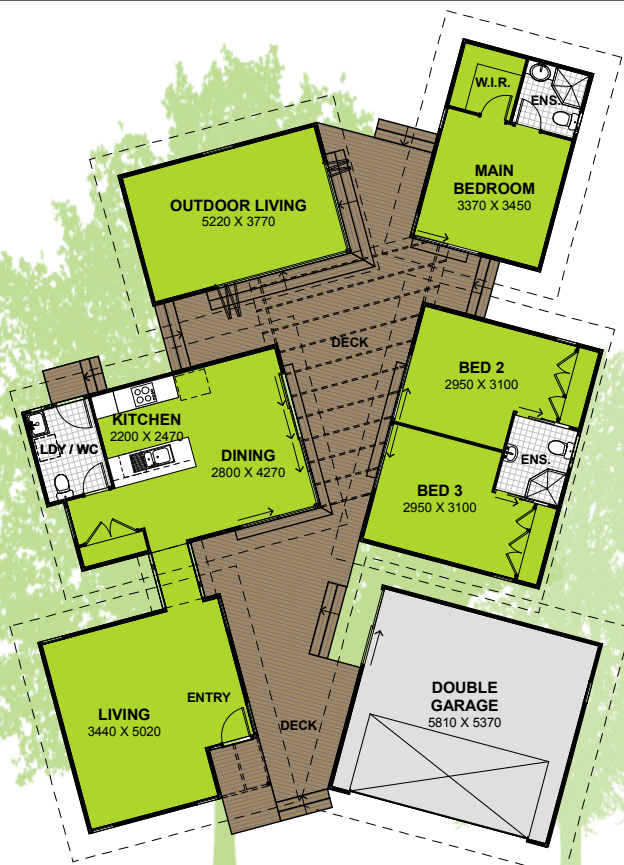

# LINDEMAN



Artists Impression



Areas m <sup>2</sup>	
Living	126.0
Garage	33.2
Decks (optional)	57.5
<b>Total Area</b>	<b>216.7</b>
<small>(optional pergola)</small>	

- Affordability
- Design Efficiency
- Environmental Design Features
- Carbon Neutral Footprint
- Energy Efficiency
- Award Winning Construction

**LIVING GREEN**  
DESIGNER HOMES  
PTY LTD

STYLE & SUSTAINABILITY



© 2009 Living Green Designer Homes Pty Ltd. All plans and images are for illustration purposes only. Living Green reserves the right to alter and change designs without notice. Bid. Lic. No. 35958 ABN 41002265492



Sales Enquiries: 02 4368 2889  
livinggreendesignerhomes.com.au